

LiftGuard™

MAGNETIC SLING PROTECTORS

by  **DICA®**

All slings, especially synthetic slings, can be damaged when lifting a load if they are not properly protected. Edge protection with sling use is critical in preventing a sling failure, and is a requirement in current sling safety standards. Cut and damaged slings are the leading cause of most rigging related accidents.

"Slings in contact with edges, corners, or protrusions should be protected with a material of sufficient strength, thickness, and construction to prevent damage to the sling" **(ANSI/ASME B30.9-1.10.4)**

"Slings shall be padded or protected from the sharp edges of their loads" **OSHA 29CFR1910.184(c)(8)**

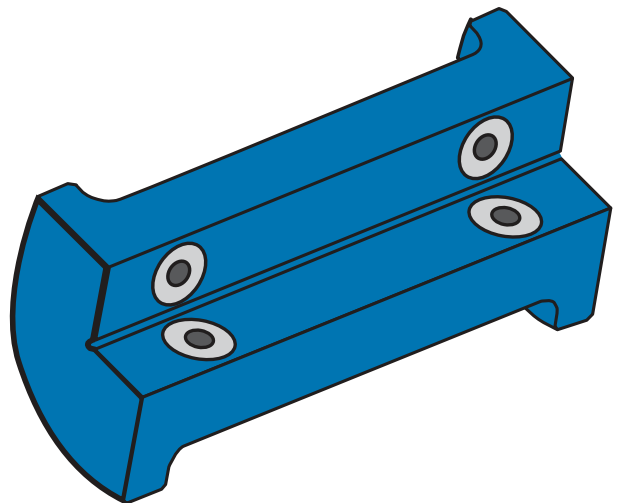

LiftGuard protectors attach with strong magnets to the steel corner and keep the sling from contacting the load.

BM 0066

LiftGuard™ Magnetic Sling Protectors are only 1/7th the weight of steel, no tools are needed since magnets allow for quick and easy attachment and removal.

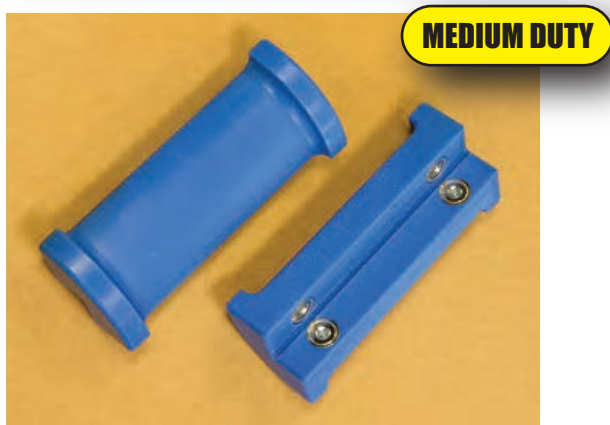
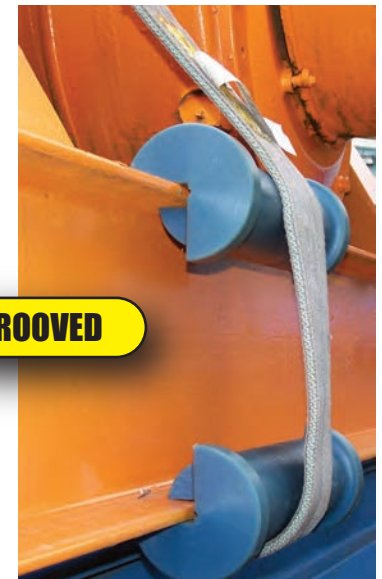
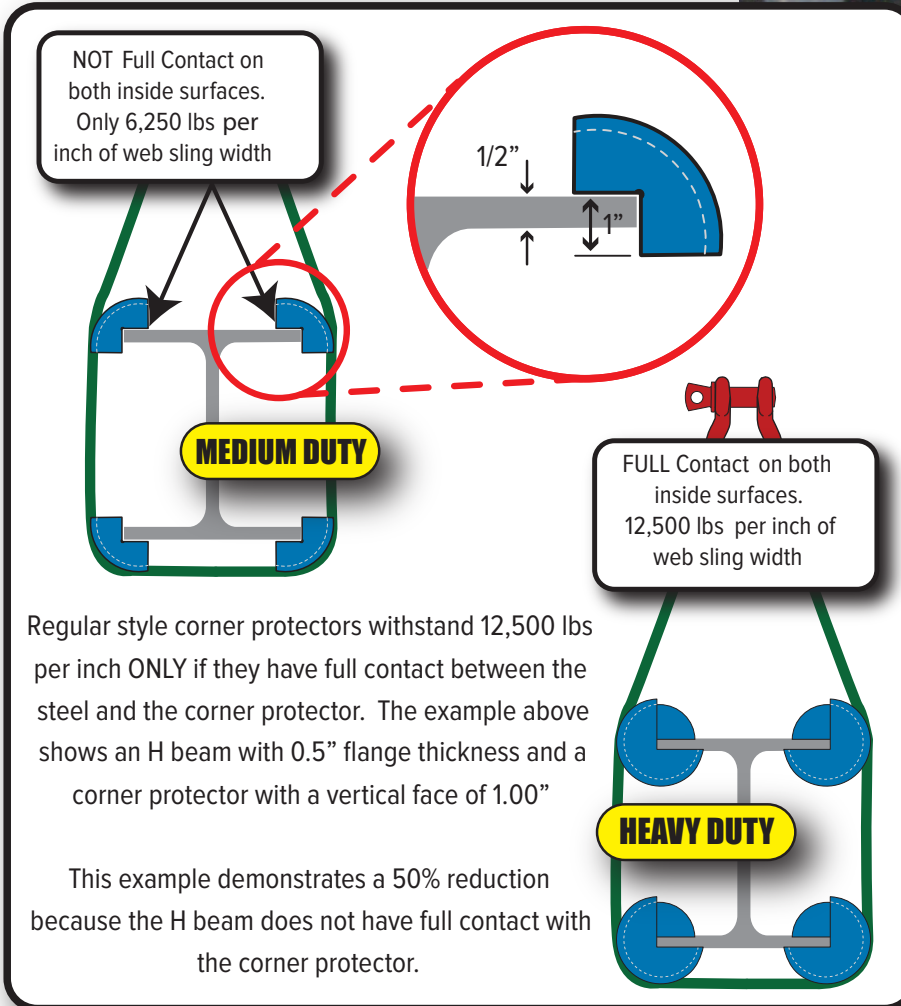
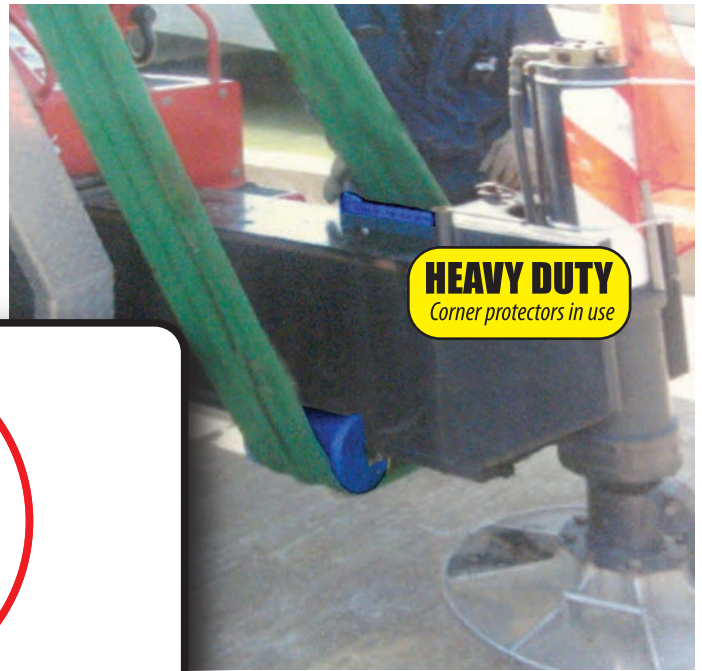

12,500 lbs per inch of web sling width only with FULL contact on inside surfaces

Visit dicausa.com/downloads for product warnings and guidelines.

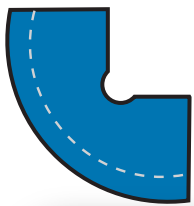

MEDIUM DUTY

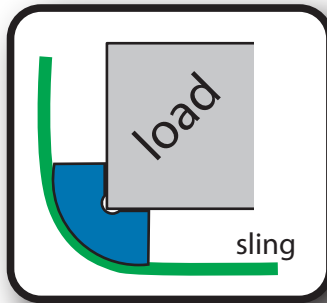

MEDIUM DUTY

Width	Part #
6"	LG-6-3-90
9"	LG-9-3-90
12"	LG-12-3-90
18"	LG-18-3-90



HEAVY DUTY

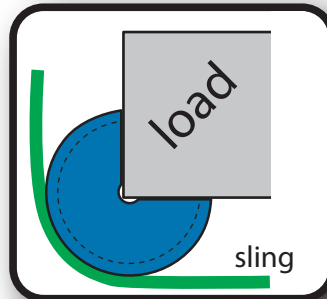

HEAVY DUTY

Width	Part #
6"	LG-6-3-270
9"	LG-9-3-270
12"	LG-12-3-270
18"	LG-18-3-270

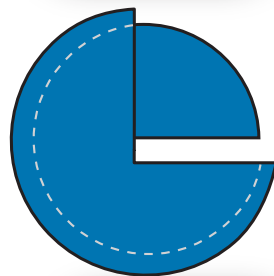
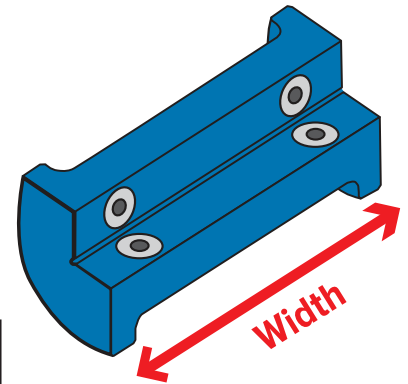

GROOVED

GROOVED

Width	Part #
9"	LG-9-2-360G-0.5
12"	LG-12-2-360G-0.5
18"	LG-18-2-360G-0.5

other sizes can be manufactured
on request

Visit dicausa.com/downloads
for product warnings
and guidelines.

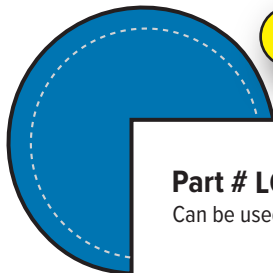

Coil Top

Part # LG-6-3-270 C Top
Can be used with all sling types

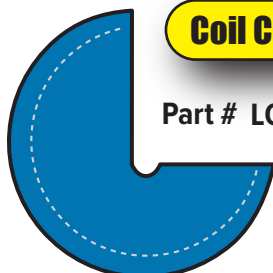
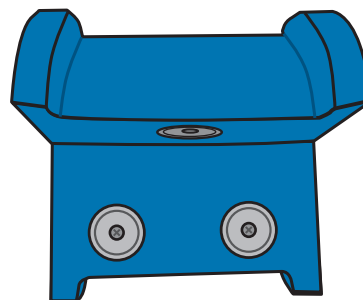

Coil Center

Part # LG-6-3-270 C Ctr

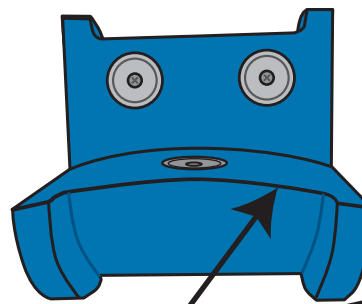

Designed for spools with a
20" inside diameter
other sizes made on request